

# Personal single gas monitor

## MODEL: O3 SERIES

ATEX intrinsic safe design

Explosion proof: Exia IIC T4 (Alkaline battery)

Ingress protection rating: IP 67

**Model GP-03**

Combustible gas detection



### Interchangeable battery

AAA(2) Alkaline battery is standard power source, Ni-MH battery can be installed as optional choice.

### Comfortable wearable design

Well-balanced weight and shape to ensure comfort wearing. Alligator clip prevents the unit from dropping.

Sensor, filter, and battery are replaceable.

Robust waterproof design and Intrinsic Safety rating make the O3 series the ideal gas monitor for many hazardous applications!



**Model OX-03**

Oxygen detection

**Model HS-03**

Hydrogen sulfide detection

**Model CO-03**

Carbon monoxide detection

### Application

- LEL monitoring for gas pipeline installations.
- LEL & CO monitoring while checking or installing gas meters.
- O2 & H2S monitoring while working in tanks, pits, or other confined spaces.
- CO monitoring in iron and steel plants.
- H2S monitoring around oil fields, refineries, petrochemical plants.

# Specifications

| Model                      | GP-03   | OX-03   | HS-03   | CO-03   |
|----------------------------|---|---|---|---|
| Gas detected               | Combustible gases   | Oxygen  | Hydrogen sulfide  | Carbon monoxide   |
| Detection principle        | Catalytic combustion  | Galvanic cell   | Electro-chemical cell   |   |
| Detection range            | 0 ~ 100%LEL   | 0 ~ 40.0%   | 0 ~ 100.0ppm  | 0 ~ 500ppm  |
| Increments                 | 1%LEL   | 0.1%  | 0.5ppm  | 1ppm  |
| Preset alarms              | 1st : 10%LEL<br>2nd : 50%LEL<br>OVER : 100%LEL  | 1st : 19.5%<br>2nd : 18.0%<br>OVER : 40.0%                        | 1st : 5.0ppm<br>2nd : 30.0ppm<br>STEL : 5.0ppm<br>TWA : 5.0ppm<br>OVER : 100.0ppm | 1st : 25ppm<br>2nd : 50ppm<br>STEL : 200ppm<br>TWA : 25ppm<br>OVER : 500ppm |
| Types of alarm*1           | Gas alarms: 2 preset alarms, Over scale alarm, STEL, TWA<br>Trouble alarms: Sensor disconnection, Low battery, Calibration error, Clock error, System error |   |   |   |
| Alarm method               | Latching  | Latching  | Latching  | Latching  |
| Display of alarm           | Gas alarms: Flashing LEDs, Buzzer, Flashing gas value, Vibration<br>Trouble alarms: Flashing LEDs, continuous buzzer, display of error message              |   |   |   |
| Operating temp. & humidity | -20 ~ +50°C [-4°F ~ 122°F]<br>0 ~ 90%RH (Non-condensing)  | -20 ~ +50°C [-4°F ~ 122°F]<br>0 ~ 95%RH (Non-condensing)          | -20 ~ +50°C [-4°F ~ 122°F]<br>16 ~ 85%RH (Non-condensing)                         |   |
| Power source               | 2 AAA size Alkaline battery (Optional AAA size Ni-MH battery [Eneeloop])  |   |   |   |
| Continuous operation*2     | Alkaline battery : Approx.35 h<br>Ni-MH battery : Approx.30 h   | Alkaline battery : Approx.3000 h<br>Ni-MH battery : Approx.2000 h |   |   |
| Response time              | 90% response within 30 sec  | 90% response within 20 sec  | 90% response within 30 sec  |   |
| Ingress proof              | IP 67   |   |   |   |
| Explosion proof            | Alkaline dry battery version : Exia II CT4<br>Ni-MH battery version : Exia II CT3   |   |   |   |
| Approvals                  | IECEX, ATEX   |   |   |   |
| Dimension & weight         | Approx. 57(W) × 70(H) × 26(D) mm [2.1(W) × 2.64(H) × 0.94(D) inches] with rubber protection cover, 80g [2.8 ounces]   |   |   |   |
| Function                   | Manual LCD backlight (Automatically ON when alarming), Peak value, Data logging, Time, CAL alarm, BUMP alarm  |   |   |   |

\*1 STEL and TWA alarms are available on HS-03 and CO-03 only. \*2 No alarm, no light at 25°C

## Accessories

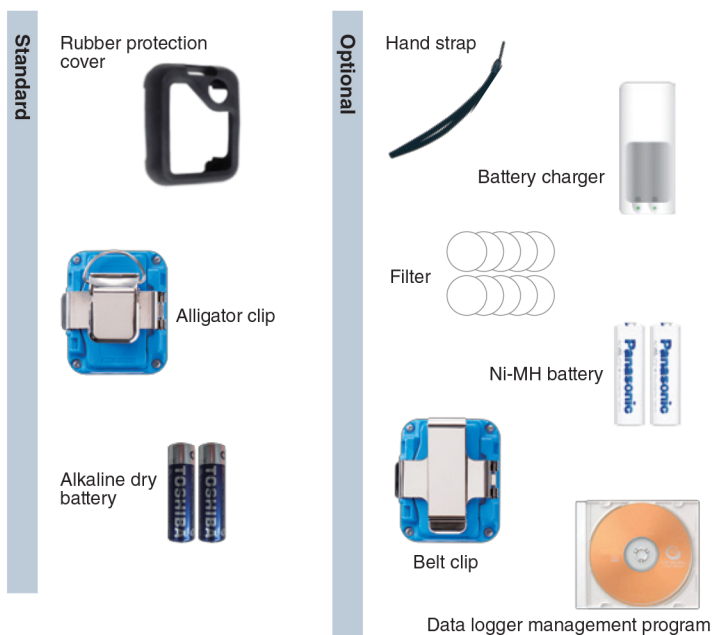

## Outer dimension

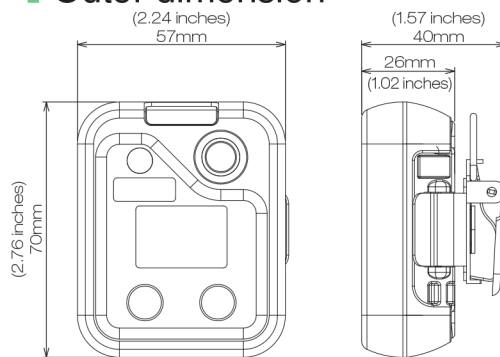

## Data logger download



★ Distributed by: